



R6 USER MANUAL





PRODUCT WARNINGS



FOR YOUR SAFETY PLEASE READ THE ENTIRE USER MANUAL BEFORE OPERATING THE MONSTERWHEEL™. THE MANUAL INCLUDES USEFUL TIPS AND TRICKS FOR USING THE MONSTERWHEEL™ AS WELL AS IMPORTANT SAFETY INFORMATION.

FOR AGES 13 YEARS AND OLDER

The MONSTERWHEEL™ is only for users who are aged 13 years and older. This device requires mature coordination, agility, and balance. Use your best judgment to determine if an individual is adequately physically fit and coordinated to use the MONSTERWHEEL™ safely.

MAX WEIGHT: 265 LBS

Do not exceed the maximum weight when operating the MONSTERWHEEL™ as this could lead to damage or failure of the device and may result in personal injury. Do not carry items when operating the MONSTERWHEEL™.

MIN WEIGHT: 45 LBS

The MONSTERWHEEL™ is not to be used by individuals weighing less than 45lbs. The MONSTERWHEEL™ sensors are designed for individuals weighing 45lbs or more, these sensors may respond incorrectly to individuals weighing less than 45lbs which can result in serious personal injury.

CLOTHING & FOOTWEAR

Wear comfortable clothing and athletic shoes with a closed toe. Do not wear open toe shoes, sandals, or high-heel shoes when operating the MONSTERWHEEL™. Do not wear loose fitting clothing as this may snag on passing objects.

PROTECTIVE GEAR

For your safety always wear a helmet and protective gear such as elbow pads and knee pads when operating the MONSTERWHEEL™.

ENVIRONMENTAL CONDITIONS

Always operate the MONSTERWHEEL™ on a smooth indoor surface or outside on flat surface in optimal weather conditions (sunny, dry). Do not operate the MONSTERWHEEL™ in wet conditions, do not navigate through puddles and avoid all contact with water.

Avoid using the MONSTERWHEEL™ in areas with debris, obstacles or slippery surfaces as these conditions can lead to losing control of the device possibly resulting in personal injury.

DRUGS & ALCOHOL

Do not operate the MONSTERWHEEL™ under the influence of alcohol or drugs, including prescription medications.

INSPECTION

Prior to each use inspect the MONSTERWHEEL™ and ensure it has been maintained correctly and is functioning properly. Do not operate the MONSTERWHEEL™ with low battery as the device may lose power resulting in loss of control and potential injury to the rider.

Keep the MONSTERWHEEL™ sufficiently charged, as draining the battery beyond the low battery threshold may result in draining the battery beyond a point which it can be charged.



MODIFICATIONS

Do not attempt to modify, repair, or replace the MONSTERWHEEL™ unit or any components of the unit, this will void any warranty and can lead to malfunctions which may cause personal injury.

MOTION

Do not lean too far forward or backward as the MONSTERWHEEL™ may not be able to accelerate or decelerate quickly enough for the rider to maintain balance, leaning to far forward or backward may result in loss of control, falling, or personal injury.

OPERATION

Do not lift the MONSTERWHEEL™ off of the ground while it is in operation and the wheels are in motion, this can result in freely spinning wheels which may cause personal injury to yourself or others nearby.

Do not jump on or off the MONSTERWHEEL™ and do not jump while using the MONSTERWHEEL™, this may result in loss of control and person injury. Always keep your feet firmly planted on the MONSTERWHEEL™ while in operation.

OBEY LAWS& REGULATIONS

Check for and adhere to local laws regarding the operation of personal transportation devices. Local laws may dictate protective gear and operation requirements. Adhere to all local vehicle, personal transportation, and pedestrian laws.

Many governmental authorities regulate the use of the MONSTERWHEEL™ on public roads and sidewalks. These laws and regulations may prescribe minimum ages for Power-Board users and may mandate protective gear for riders. You should consult local authorities to become familiar with applicable laws and regulations.

BATTERY SPECIFICATIONS

NAME	PARAMETERS
Battery	Lithium-ion battery
Charging Time	2 - 3 Hours
Voltage	36 V
Amp Hours	4.4 Ah
Working Temperature	5°F - 122°F
Charging Temperature	32°F - 104°F
Relative Humidity of Storage	5% - 95%

BATTERY CAUTION & DISPOSAL INFORMATION

- Keep away from dangerous goods or materials, burn hazard.
- Abusive operation of battery (overcharge, crush, puncture, excessive heat or moisture) may produce smoke.
- In such an event, ventilate the area.
- Extinguish any flames with carbon dioxide, dry – powder fire extinguisher, or cover with sand or mud.

- **WARNING** – Risk of Fire and Electric Shock – No User Servicable Parts.
- Warranty void if the security seal is punctured, broken or tampered with.
- Do not expose to temperatures above 140°F.
- Do not throw the battery away in the trash or in fire. Batteries should be recycled or disposed of as per state or local guidelines.
- For normal charges, the battery temp should be between 32°F / 114°F, the charge time may increase at colder temperatures.
- Use at temperature below 104°F, charge fully prior to long storage periods or if it has been stored for more than three months.
- Do not charge unattended. Do not charge for more than 8 hours. Do not charge while hot.
- For service, contact Powerboard support at 480-535-4985.
- Use Only CD (Coming Data) CP3615 Charger



CONGRATULATIONS ON YOUR NEW MONSTERWHEEL

The MONSTERWHEEL™ is an innovative and fun personal transportation device. For your safety read this guide in its entirety, including the warnings portion of this manual, prior to riding the MONSTERWHEEL™ for the first time.

INCLUDED IN THIS BOX:

MONSTERWHEEL™



Battery Charger / Power Cord



Instruction Manual & Warnings



WARNING: TO REDUCE THE RISK OF ELECTRIC SHOCK OR FIRE, DO NOT EXPOSE THIS PRODUCT TO RAIN OR MOISTURE. DO NOT REMOVE COVER. NO USER SERVICEABLE PARTS INSIDE. REFER SERVICING TO QUALIFIED SERVICE PERSONNEL.



WARNING! THE CELLS WITHIN THE BATTERY PACKS CONTAIN TOXIC SUBSTANCES. DO NOT ATTEMPT TO OPEN BATTERY PACKS. DO NOT USE THE BATTERY PACK IF ITS CASING IS BROKEN OR IF IT EMITS AN UNUSUAL ODOR OR EXCESSIVE HEAT OR LEAKS ANY SUBSTANCE. DO NOT HANDLE A DAMAGED OR LEAKING BATTERY PACK.

SET UP & CHARGING

1. Remove the MONSTERWHEEL™ Battery Charger and Power Cord from the product packaging.
2. Connect the Power Cord to the Battery Charger.
3. Insert the Battery Charger into the charging port found next to the MONSTERWHEEL™ power button.
4. Insert the Power Cord into an electricity socket.
5. Charge the MONSTERWHEEL™ for a minimum of 2-3 hours before first use.
6. Recharge the MONSTERWHEEL™ after each use.

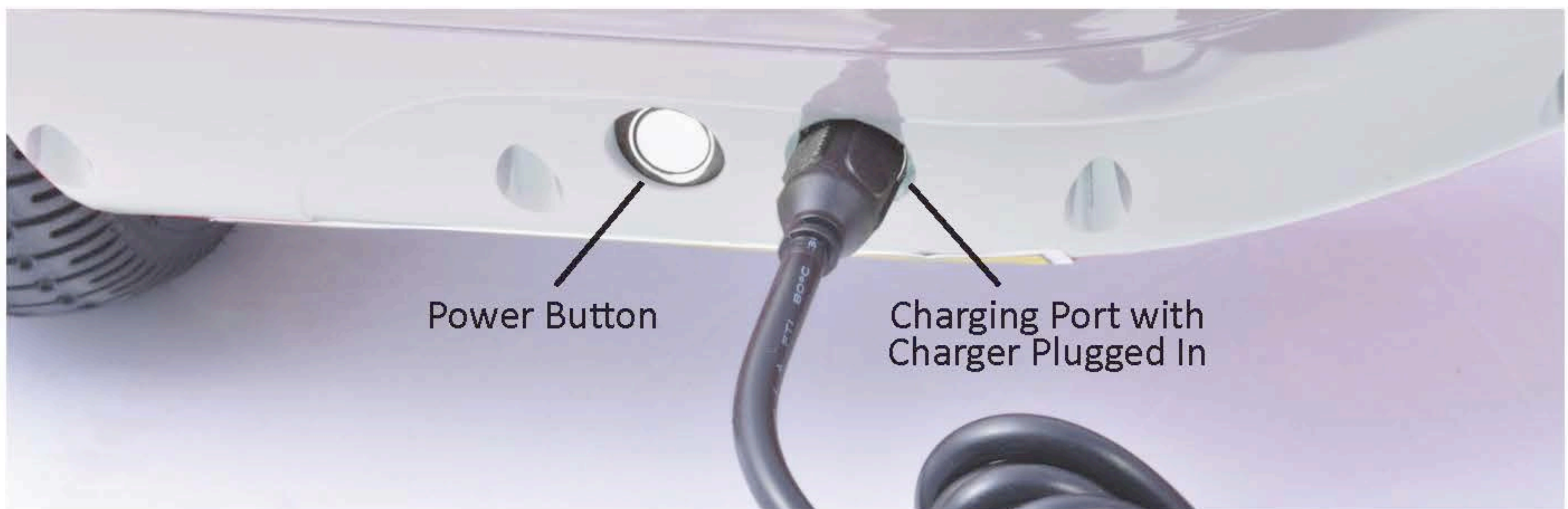

STORAGE

If you do not use the MONSTERWHEEL™ on a regular basis be sure to store it fully charged and charge it occasionally (approximately once every 60 days) as the battery will drain over time.

BATTERY LEVEL LIGHT

The Battery Level Light is found on top of the MONSTERWHEEL™. Use this light to determine the remaining charge of the MONSTERWHEEL™.

A GREEN light indicates the MONSTERWHEEL™ is fully charged or sufficiently charged for use.

A RED light indicates the remaining battery level is below 10% and requires charging. When the battery level is low the MONSTERWHEEL™ will also beep to alert the rider to stop and charge the unit.

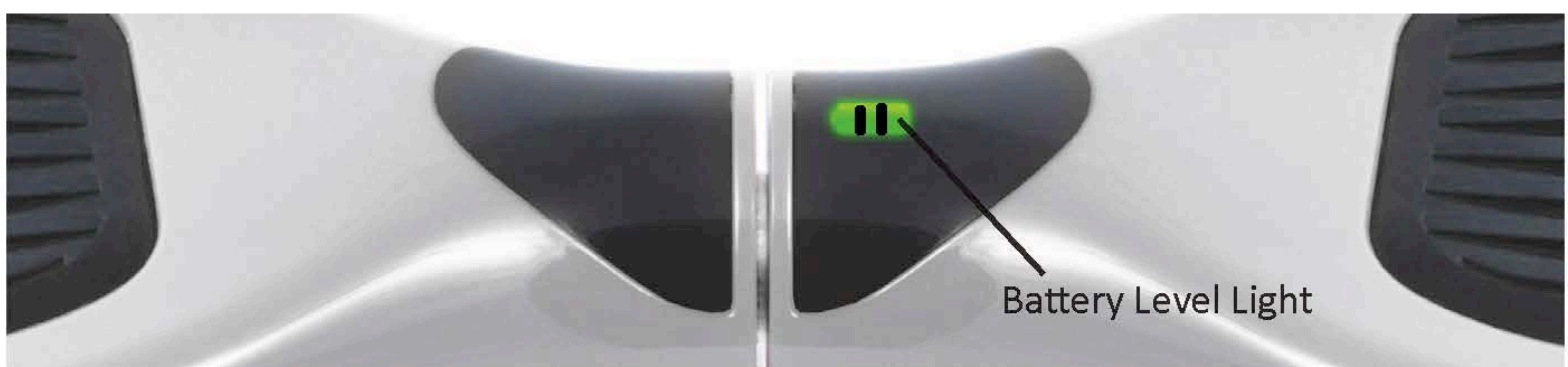



HOW TO USE YOUR MONSTERWHEEL™

For your safety it is recommended to wear protective gear such as a helmet, elbow pads, knee pads, etc, when operating the MONSTERWHEEL™.

The power button is located next to the charging port on the MONSTERWHEEL™. Press it until you hear the MONSTERWHEEL™ beep to turn it on or off.

When riding the MONSTERWHEEL™ wear comfortable, non-restrictive clothing and athletic shoes with a closed toe. Clothing should not be so loose that a garment may be caught on a passing object or in the wheels; this could result in loss of control and personal injury.

When standing on the MONSTERWHEEL™ keep feet shoulder width apart. Do not stand on the center portion of the MONSTERWHEEL™. Keep a relaxed, upright posture with your knees slightly bent.

The range of the MONSTERWHEEL™ is dependent upon the way you use it. The battery will run out more quickly if you ride at higher speeds and/or up or down an incline.

GETTING ON AND OFF THE MONSTERWHEEL™

The MONSTERWHEEL™ works in both directions, there is no correct front or back of the unit.

IMPORTANT: Be careful getting on and off the MONSTERWHEEL™ and use stable objects for assistance when learning to get on and off. Always step forward when getting on the MONSTERWHEEL™ and step backward when getting off the MONSTERWHEEL™, getting on or off the MONSTERWHEEL™ in any other manner may result in a fall and personal injury.

GETTING ON THE MONSTERWHEEL™

1. Place the MONSTERWHEEL™ on level ground in front of you.
2. Turn the MONSTERWHEEL™ on and make sure the Battery Level Light is green (indicating the unit is charged).
3. Using your dominant foot step forward and place your foot lightly onto the MONSTERWHEEL™.
4. Stabilize the MONSTERWHEEL™ by finding the correct balance with your dominant foot.
5. Once you have stabilized the MONSTERWHEEL™ begin to shift your weight to your dominant foot and quickly bring your other foot onto .
6. Stabilize yourself.

GETTING OFF THE MONSTERWHEEL™

1. Bring the MONSTERWHEEL™ to a complete stop.
2. Using your dominant foot, angle your toes slightly downward to prevent the MONSTERWHEEL™ from moving backward.
3. Quickly step backward with your non dominant foot and place your foot on the ground.
4. Once you have stable footing on the ground take your dominant foot off the MONSTERWHEEL™. You should now be safely on stable ground.



RIDING THE MONSTERWHEEL™

Moving Forward – Lean forward on both platforms and/or point your toes downward to instruct the MONSTERWHEEL™ to move forward.

Moving Backward – Lean backward on both platforms and/or rock your heels backward to instruct the MONSTERWHEEL™ to move backward.

Turning Right – Point your left toes downward, rotating the platform forward, to instruct the MONSTERWHEEL™ to turn right.

Turning Left – Point your right toes downward, rotating the platform forward, to instruct the MONSTERWHEEL™ to turn left.

IMPORTANT: Accelerate and decelerate at a safe, moderate pace. Accelerating or decelerating too quickly may result in loss of balance/control and potential injury.

Avoid turning sharply at speed, this will likely result in losing control of the MONSTERWHEEL™. Avoid riding over loose objects, cracks, raised bumps, or potentially hazardous terrain. Do not ride the MONSTERWHEEL™ down steps.

IMPORTANT: Please note that the MONSTERWHEEL™ only has a pitch state estimator for controlling the movement of each pedal, and the device has no dedicated yaw input. The MONSTERWHEEL™ lacks any method for a user to give a yaw input to the device

Top Speed – The MONSTERWHEEL™ is capable of traveling at speeds up to a maximum of 6.5 mph (10 km/h) MPH. The MONSTERWHEEL™ will beep when it has reached the max speed of 6.5 mph warning others around you of your presence and speed. Be careful when operating the MONSTERWHEEL™ at high speeds, riders should wear protective gear and be very careful of their surroundings.

IMPORTANT: Calculation of the 10kph top speed is NOT done using a balancing margin. It is based solely on comparing the riders current actual speed with a fixed threshold of 10kph. The MONSTERWHEEL™ is unable to make a calculation of balancing margin to determine how much acceleration the MONSTERWHEEL™ can deliver at a given moment. The MONSTERWHEEL™ controller merely knows present velocity based on actual speed and a fixed 10kph limit.

ADDITIONAL IMPORTANT NOTE: If a user does reach and exceed the 10kph maximum suggested speed, the only result is an audible alarm. The board WILL NOT push back against you, and if you continue leaning forward you may easily fall off the board. There is also no tactile alarm, the MONSTERWHEEL™ does not use tactile alarms of any sort.

RESEPECT YOUR SURROUNDINGS AND THOSE AROUND YOU

Be mindful of your speed and surroundings for your own safety and the safety of those around you. Be prepared at any moment to come to a complete stop and always allow safe space between yourself and other objects and people so you can stop to avoid them.



2921 West Central Ave Unit D, Santa Ana, CA 92704

www.bestbuy888.com

info@glaremonsterwheel.com

714-957-2817

WARRANTY

This MONSTERWHEEL™ is warranted to be free of defects of material or workmanship for one year from the date of original retail purchase. This limited warranty extends to the original purchaser with proof of purchase. If any component of this product proves defective, repair or replacement with the same or equivalent product will be made without charge. Warranties do not apply when products are not used in accordance with the included instruction manual, or in cases of misuse or abuse. For more information, see WWW.BESTBUY888.COM

CERTIFICATE OF WARRANTY CARD	
Product Model	Product Name
Date of Purchase	Purchase Location
Retailer's Name	Retailer Telephone Number
Retailer's Address	
Briefly Describe the Problem With the Product	